

Recommended Tools

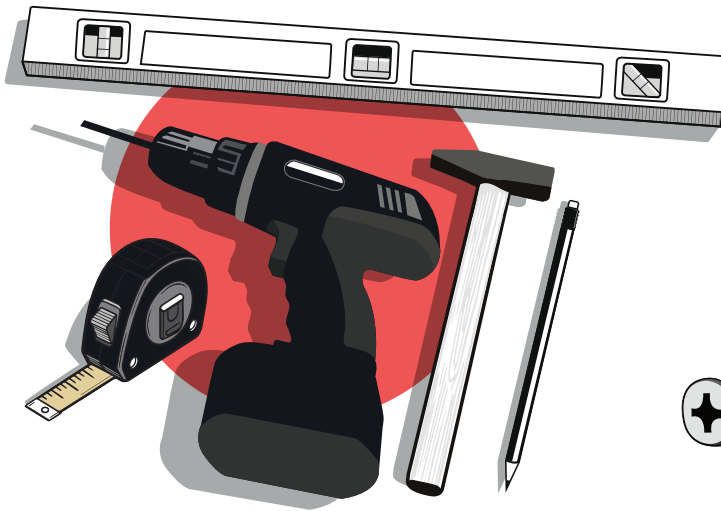

Hardware Supplied

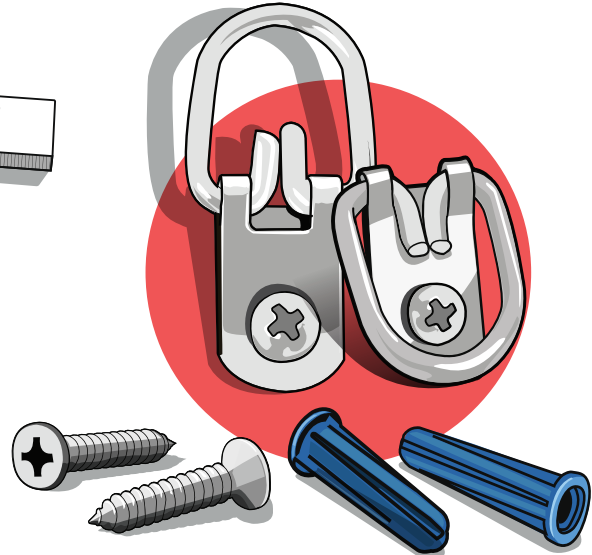

Gather your materials – wall anchors and screws (included with your art), **Hammer, Pencil, Tape Measure, Level,** and a **Drill with a 3/16" drill bit.**

Now, let's hang it on the wall!

Step 1

Flip the artwork over and take the measurement using a tape measure from hanger to hanger on the back. Write it down on a piece of paper so you can refer to it when you're ready to make the holes in the wall

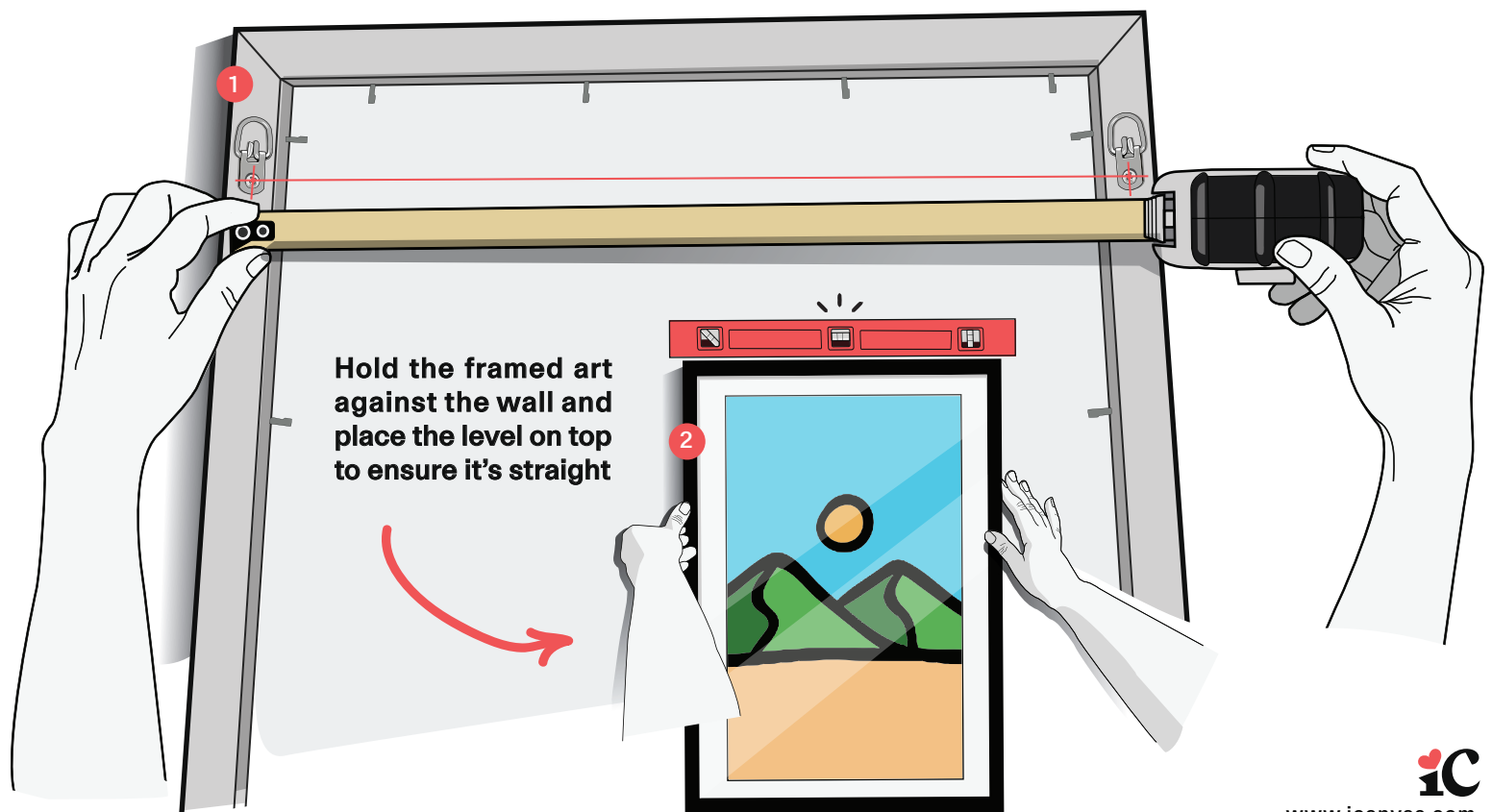

Step 2

Hold the artwork steady, then use a pen to draw a straight line as a guide for the next step, marking the points according to the measurement you previously took



Use a level or a ruler to mark the measurement you took earlier.

Mark two points, one at zero and one at the correct measurement distance.

You can also mark the midpoint to help maintain proper symmetry.

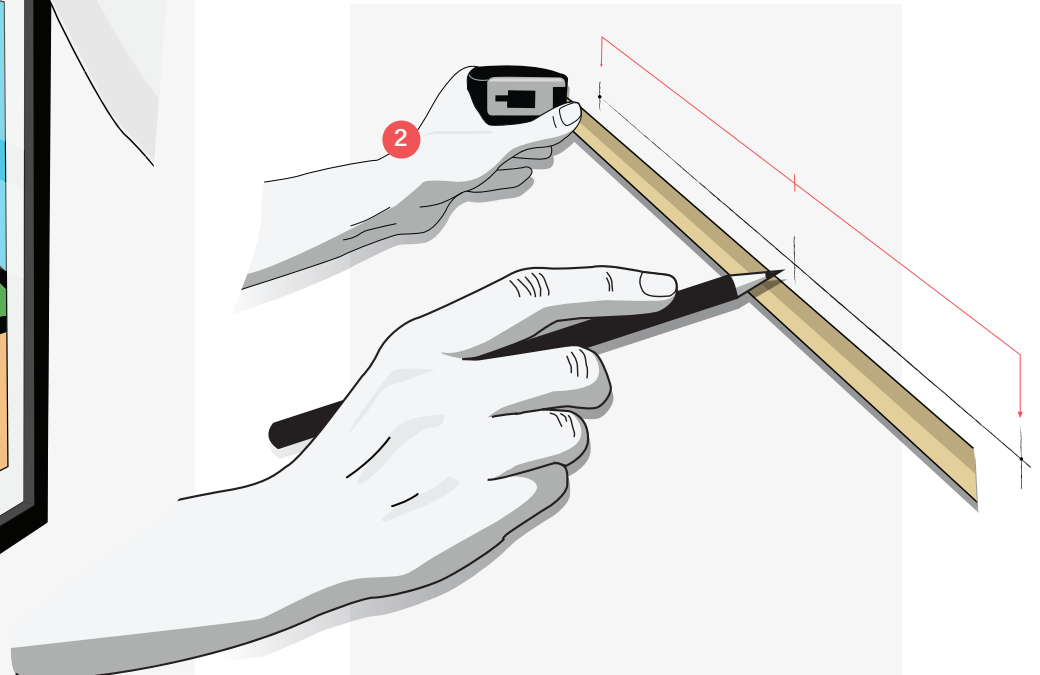

Step 3

Drill small holes where the anchors will go, then hammer the wall anchors flush with the wall

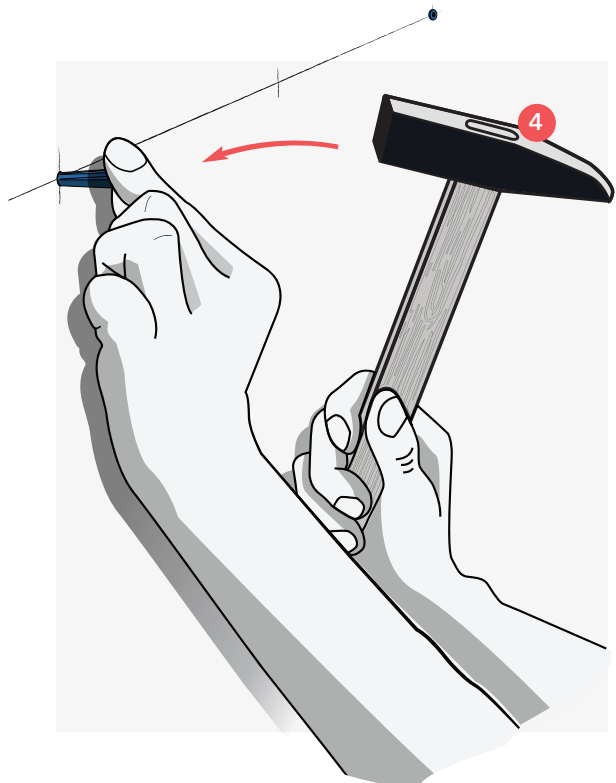

Step 4

Drill the screws into the wall anchors, leaving about $\frac{1}{4}$ inch of each screw protruding. Gently hang your art on the screws, then step back to ensure it is level.

